

Truck Drawbar Holder – 2 Pockets

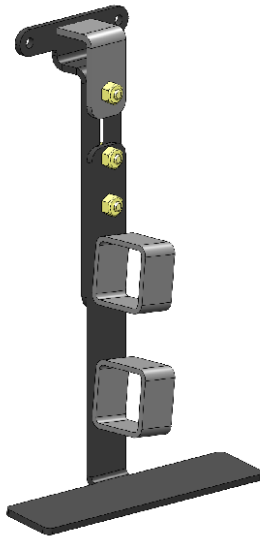

Painted Black

TRUCK DRAWBAR HOLDER

The Drawbar Holder is an adjustable holder that fits in normally wasted space behind the wheel well in most pickup truck beds.

IMPORTANT SAFETY INFORMATION

1. Do not modify or add to the product.
2. Never strike any part of the item with a steel hammer.
3. Do not weld on this product.
4. Maximum 60 lb. load in Drawbar Holder



INSTALLING TRUCK DRAWBAR HOLDER

The Drawbar Holder installs easily by using included nuts, bolts & bracket that clamps to the lip of the bed rail. Slide the adjustable bracket behind the top truck rib, place clamp on the outside of the rib, tighten three bolts with 9/16 wrench (torque bolts to 10 ft/lb). If desired you can drill holes in the lip of the bed rail and mount instead of clamping. (mounting bolts not included).

The bracket can be adjusted up or down to fit truck box heights From 15”– 24” . We recommend mounting behind the wheel well on the driver’s side as it is only on this side that the pockets point down towards the wheel well.

www.powerpin.ca

Warranty

This product is to be free from defects in material and workmanship for a period of one year from date of shipment. Parts must be properly installed. Any product which has been altered, Modified, misuse, or lack of maintenance will not be considered under warranty. Authorization from Power Pin Inc. must be obtained before returning any part. The sole responsibility of Power Pin Inc. under this warranty is limited to repairing or replacing any parts which are returned, prepaid, and are found to be defective by Power Pin Inc. No charges for transportation or labor performed on this product will be allowed under this warranty.